

FOR SALE

RESIDENTIAL - APARTMENT 904SQFT (84SQM) / CALL FOR PRICE!

+65 9721 4313



1 - Bedroom

TYPE A

A1: 904sqft
A2: 904sqft
A3: 904sqft
A4: 904sqft
A5: 904sqft
A6: 904sqft
A7: 904sqft
A8: 904sqft
A9: 904sqft
A10: 904sqft

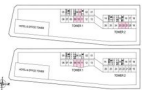

RESIDENTIAL - APARTMENT

VILLAGE NO 14, SAMDECH HUN SEN ROAD, TONLE BASSAC COMMUNE, CHAMKARMORN DISTRICT,

- LISTING ID: SGLD10357721
- TENURE: FREEHOLD
- TITLE: N/A
- SIZE BUILT-UP: 904SQFT (84SQM)
- SIZE LAND: 3.131AC (1.267HA)
- NO. OF FLOORS: 55
- FLOOR/LEVEL: N/A - N/A
- BED ROOMS: 1
- BATH ROOMS: 1
- MAIDS ROOMS: N/A
- PARKING SPACES: N/A
- LAYOUT TYPE: OTHER
- FACING: N/A
- VIEWING: N/A
- SELLING PRICE: **CALL FOR PRICE!**
- COMPLETION YEAR: 2020
- CONDITION: ORIGINAL CONDITION
- FURNISHING: PARTIALLY FURNISHED
- LISTING DATE: OCT 29, 2019

THE PEAK

Spacious 904sqft (84sqm), partially furnished, 1 bedroom, 1 bathroom Apartment for Sale. Completed in 2020, this unit is in original condition. Others: Freehold Location: Phnom Penh, Cambodia

INTERIOR FACILITIES

- Air-Conditioning
- Walk-In-Wardrobe

OTHER INTERIOR FEATURES

- Cooker Hob/Hood
- Water Heater

EXTERIOR FACILITIES

- 24 Hours Security
- Covered Car Park
- Function Room
- Jacuzzi

VISIT THIS PROPERTY AT: <https://www.jennylallalee.sg/property/SGLD10357721>

JENNY LEE - HUTTONS ASIA PTE LTD

3 Bishan Place #05-01 CPF Bishan Building
D20, 579838, Singapore

+65 9721 4313
WhatsApp Me

sgrealtor65@gmail.com

<https://www.jennylallalee.sg>



Scan QR Code

L3008899K
R011594D

Huttons Call for Viewing
The Agency of Choice +65 9721 4313